

COLPHENE[®] LM BARR

Universal Waterproofing Barrier

Waterproofing

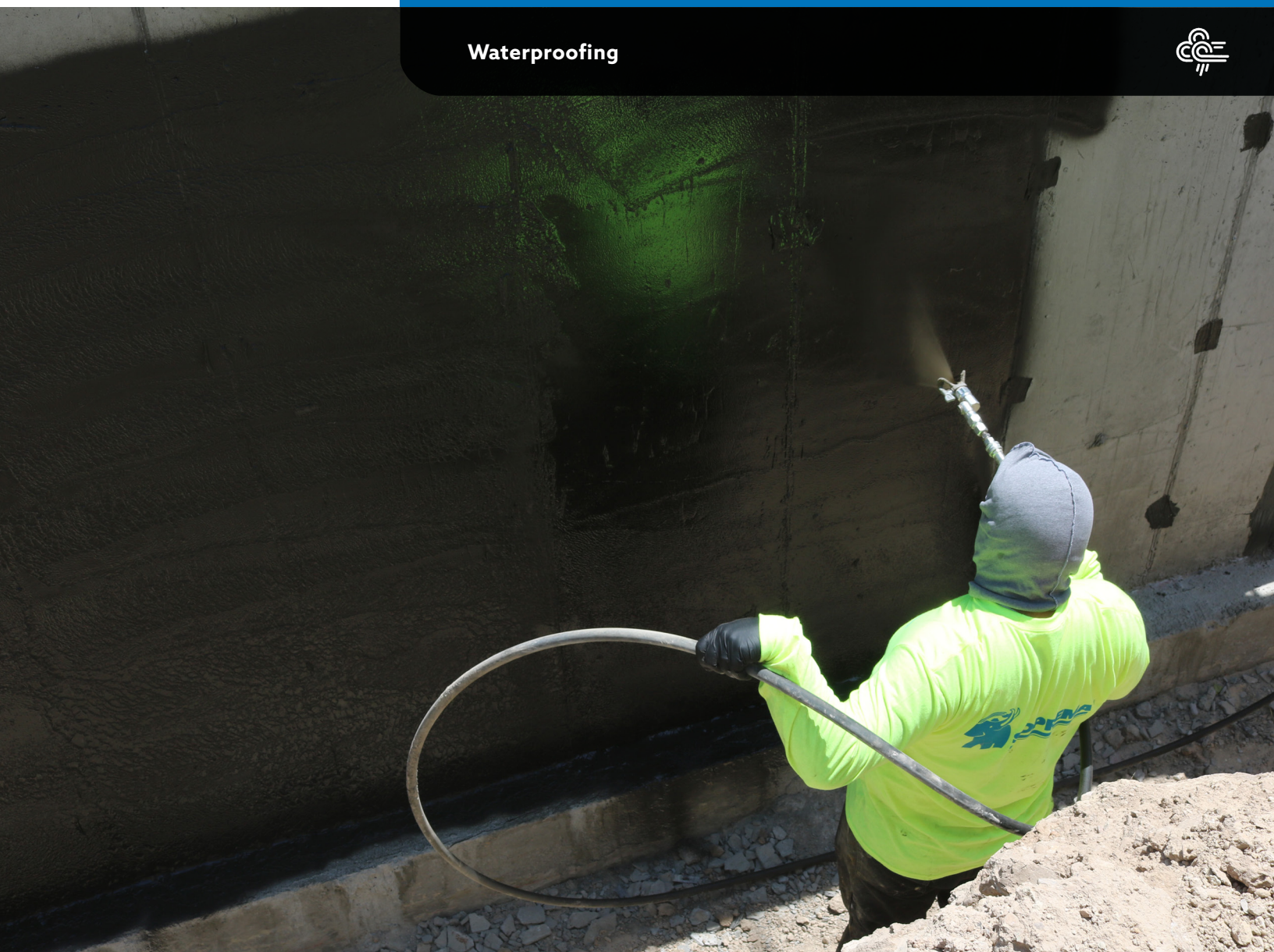



COLPHENE LM BARR

COLPHENE LM BARR is a single component, liquid applied, moisture curing elastomeric waterproofing membrane. COLPHENE LM BARR is ideal as a positive-side waterproofing for sealing foundations. It can also be used in between slab waterproofing, equipment wells, and other underground construction. In above grade applications, use COLPHENE LM BARR to waterproof planter boxes, sealing parapets, plaza decks and green roof systems. COLPHENE LM BARR is available in both spray and squeegee grades.

- The first spray grade STPE waterproofing membrane to make installation fast and easy with minimal preparation work – truly a time saving solution
- Polyether/STPE technology combines the best of both worlds: persistent adhesion to concrete while allowing movement of the building with extremely high elongation properties
- One pass application up to 120 mils (3.0 mm)
- Moisture cure allows COLPHENE LM BARR to bond to 'green' concrete, which allows you to coat the concrete sooner as opposed to emulsion-type or cutback products which can blister with moisture
- High solids content that prevents shrinking or pulling away from the concrete
- Fast cure reduces construction sequencing time by reducing backfill wait times
- Rain safe in minutes

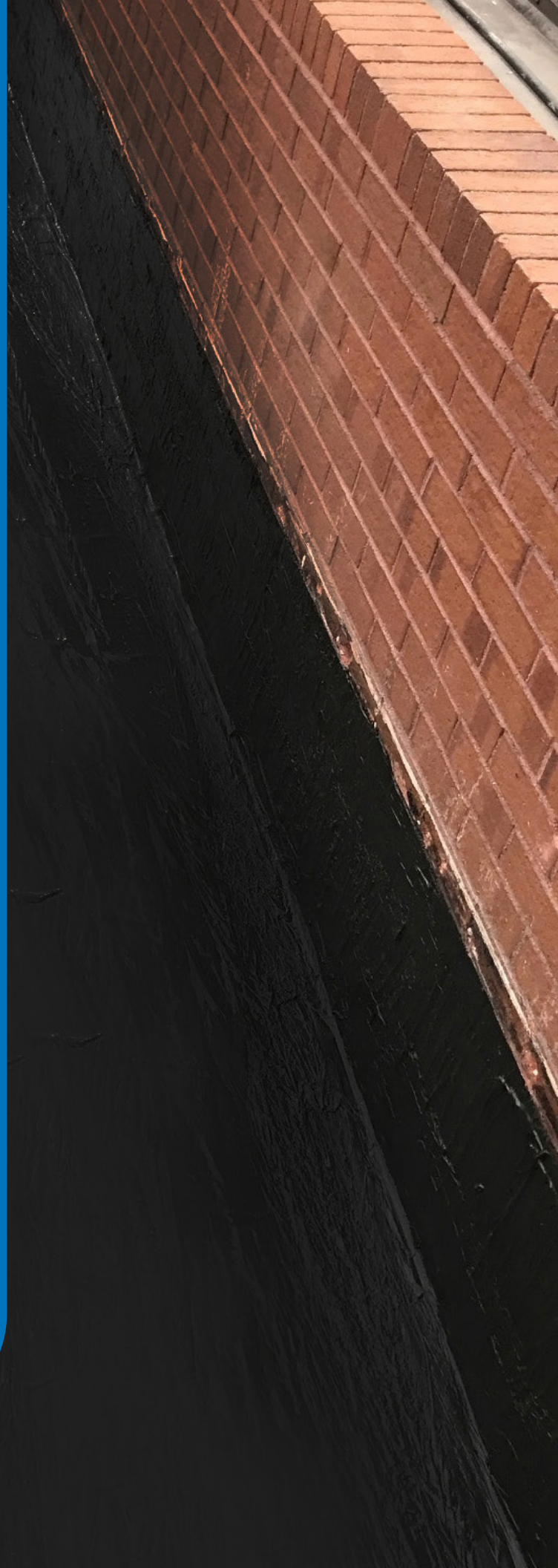



SUCCESS STORY

ANB Bank offers customers personal and business banking, as well as financial services with a company that is dedicated to keeping their financials safe. By providing creative and flexible one-on-one solutions, ANB Bank puts their customers first, and with thirty locations across Colorado, Wyoming and the Kansas City metro area a branch is always near.

When the Denver ANB Bank was to go through a remodel, SOPREMA's COLPHENE LM BARR product was selected to waterproof the building. With a tight deadline and existing concrete preparation to take into consideration, COLPHENE LM BARR was the perfect solution due to its excellent performance qualities. With COLPHENE LM BARR's STPE moisture cure technology, the new and improved ANB Bank will have a continuous waterproofing layer that can withstand extreme cold and high temperatures without cracking or softening for many years to come.

ANB BANK
Denver, Colorado



BELOW GRADE ASSEMBLY

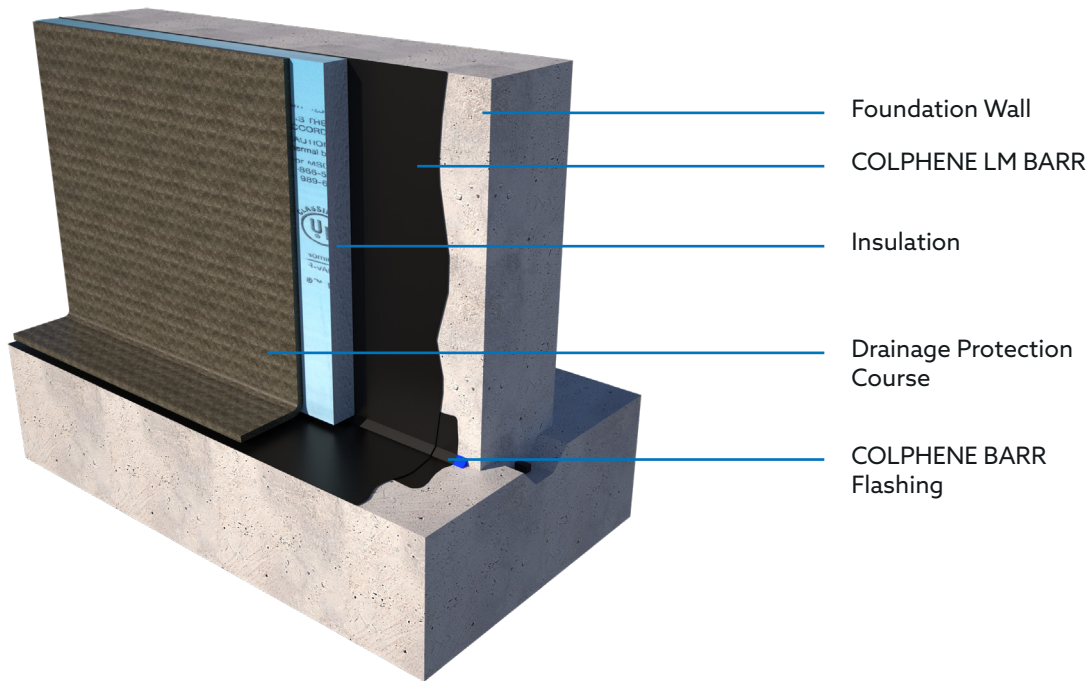

PRODUCTS AND SIZES AVAILABLE



COLPHENE LM BARR

COLPHENE LM BARR is a single component, 98% solids content, liquid applied, moisture curing elastomeric waterproofing membrane. COLPHENE LM BARR's STPE moisture cure technology forms a continuous, tough elastic seal to the substrate that withstands extreme cold and high temperatures without cracking or softening. Available in 5 gallon (19 L) pails.



COLPHENE LM BARR FLASHING

COLPHENE LM BARR Flashing is a single component, 100% solids content, liquid applied, moisture curing elastomeric waterproofing membrane. COLPHENE LM BARR Flashing's STPE moisture cure technology forms a continuous, tough elastic seal to the substrate that withstands extreme cold and high temperatures without cracking or softening. Available in 3.5 gallon (13 L) pails or 20 ounce (591 ML) sausages.



COLPHENE LM BARR SPRAY

COLPHENE LM BARR Spray is a single component, 95% solids content, liquid applied, moisture curing elastomeric waterproofing membrane. COLPHENE LM BARR Spray's STPE moisture cure technology forms a continuous, tough elastic seal to the substrate that withstands extreme cold and high temperatures without cracking or softening. Available in 5 gallon (19 L) pails or 50 gallon (189 L) drums.



SOPRAFLASH R

SOPRAFLASH R is a lightweight, thermally bonded, spunlaid polyester/nylon composite mat. SOPRAFLASH R is a reinforcing non-woven mesh used to reinforce SOPREMA's waterproofing liquid membranes such as COLPHENE H, COLPHENE H-EV, COLPHENE LM BARR and COLPHENE LM BARR SPRAY.



POLYFLEECE FLASHING

Polyfleece Flashing is a proprietary woven polyester reinforcement used in conjunction with liquid applied resins.

PLAZA DECK ASSEMBLY

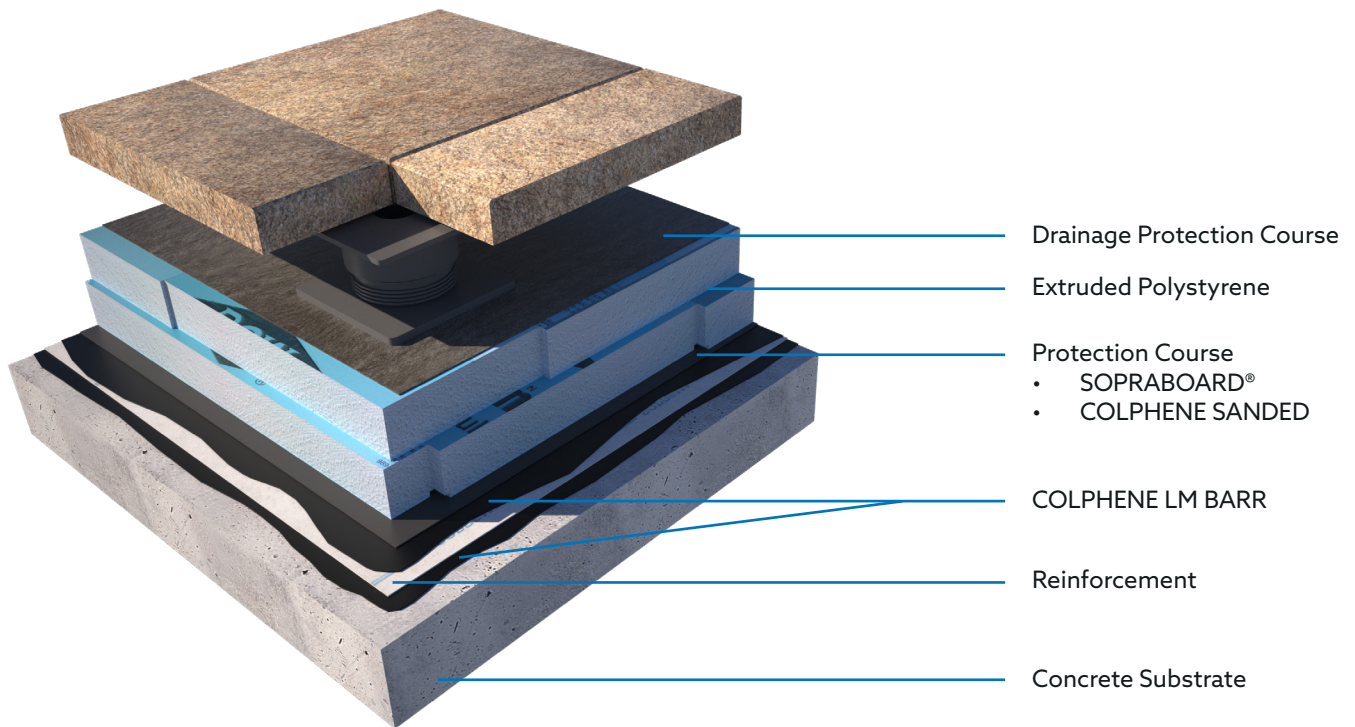

TESTING AND APPROVALS

Meets the testing and performance requirements of:

ASTM D5385: Standard Test Method for Hydrostatic Pressure Resistance of Waterproofing Membranes

ASTM C836: Standard Specification for High Solids Content, Cold Liquid-Applied Elastomeric Waterproofing Membrane for Use with Separate Wearing Course



PLANTER ASSEMBLY

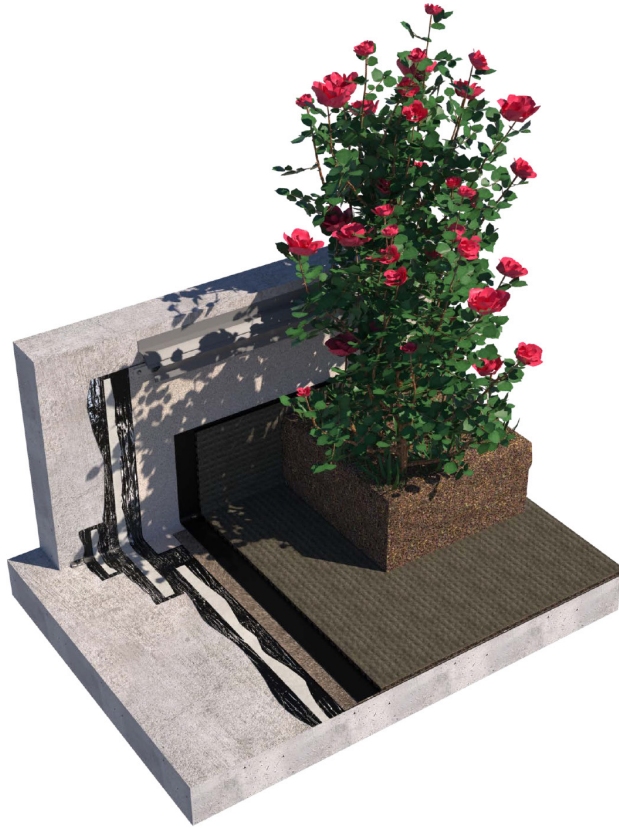

TESTING AND APPROVALS

Meets the testing and performance requirements of:

ASTM D5385: Standard Test Method for Hydrostatic Pressure Resistance of Waterproofing Membranes

ASTM C836: Standard Specification for High Solids Content, Cold Liquid-Applied Elastomeric Waterproofing Membrane for Use with Separate Wearing Course



INNOVATION SINCE 1908

SOPREMA has developed around the idea that the quality, durability and reliability of materials must match builders' ambitions and expectations. For more than 100 years, SOPREMA has been using its expertise to develop a variety of high-end products that meet or exceed all the requirements of the construction field.

ROOFING WATERPROOFING WALLS CIVIL ENGINEERING



SOPREMA is an international manufacturer specializing in the production of waterproofing and insulation products, as well as vegetative and soundproofing solutions, for the building and civil engineering sectors.

SOPREMA.US • 1.800.356.3521 SOPREMA.CA • 1.877.MAMMOUTH
