

NON-MOVING CRACK (1mm OR Less)

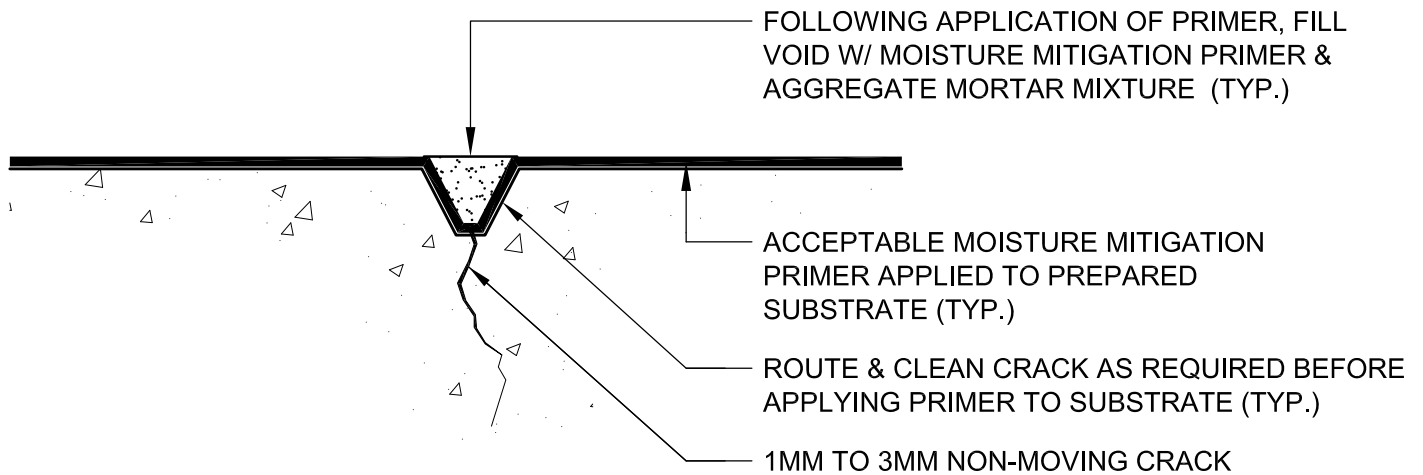

NON-MOVING CRACK (1mm TO 3mm)

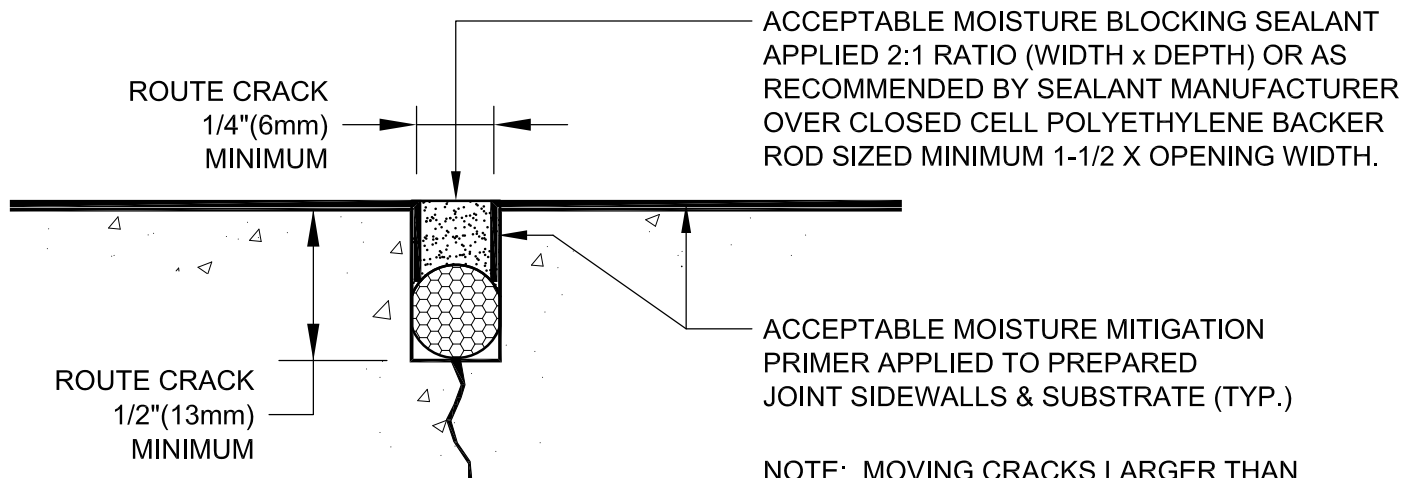

NOTE: MOVING CRACKS LARGER THAN 1.5mm WIDTH MUST BE TREATED AS AN EXPANSION JOINT.

MOVING CRACK 1.5mm MAXIMUM WIDTH

NOTE: REFER TO SOPREMA RELATED PUBLISHED DOCUMENTATION, PRODUCT DATA SHEETS (PDS) & SAFETY DATA SHEETS (SDS) FOR ADDITIONAL INFORMATION. ALL DETAIL DRAWINGS & RELATED INSTALLATION GUIDELINES ARE PROVIDED BY SOPREMA FOR THE SOLE PURPOSE OF SOPREMA WARRANTY QUALIFICATION. ACCORDINGLY, ANY DETAILS DRAWINGS PROVIDED ARE NOT OFFERED AND SHOULD NOT BE CONSIDERED A SUBSTITUTE FOR PROFESSIONAL DESIGN SERVICES. USAGE OF THIS DRAWING IS GOVERNED BY THE TERMS OF SERVICE FOR SOPREMA DETAIL, PLEASE CONSULT THESE TERMS OF SERVICE PRIOR TO UTILIZING THIS DRAWING.

310 QUADRAL DRIVE
WADSWORTH, OHIO 44281
(330) 334-0066

**MOISTURE MITIGATION PRIMER
CRACK TREATMENT**

DRAWING NO.:
RS-J1F

REVISION	ISSUE DATE	SCALE	DRAWN BY	
0	12-15-2018	N.T.S.	DRW	RS_J01F