

**NOTE:**

1. SIZE WIDTH OF DE-BONDING TAPE TO PROVIDE UN-ADHERED AREA MINIMUM 5 TIMES LARGER THAN THE MAXIMUM ANTICIPATED EXPANSION. MEMBRANE COVER STRIP MUST EXTEND PAST DE-BONDING AS INDICATED BELOW (TYP.)

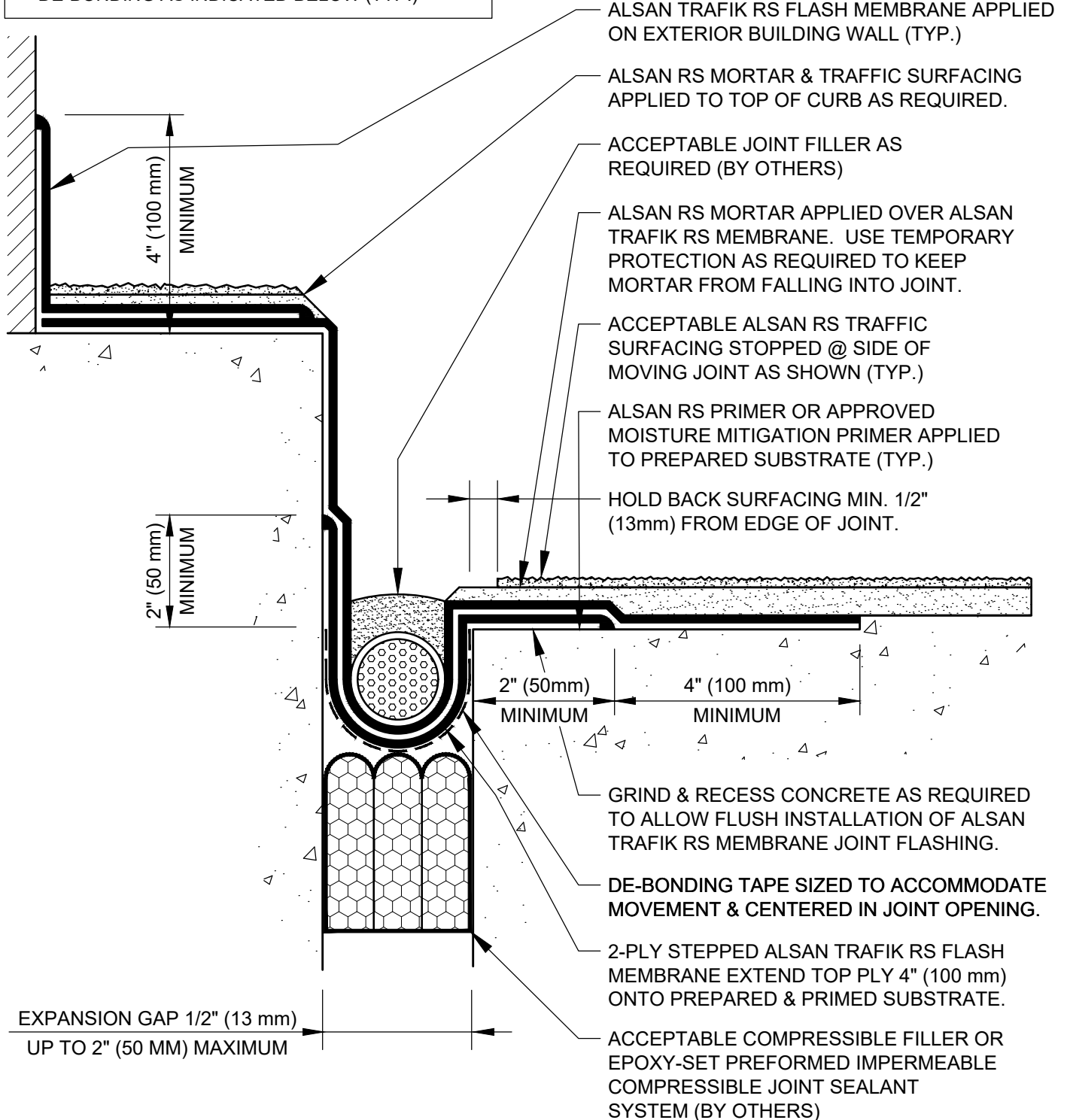

ALSAN TRAFIK RS FLASH MEMBRANE APPLIED ON EXTERIOR BUILDING WALL (TYP.)

ALSAN RS MORTAR & TRAFFIC SURFACING APPLIED TO TOP OF CURB AS REQUIRED.

ACCEPTABLE JOINT FILLER AS REQUIRED (BY OTHERS)

ALSAN RS MORTAR APPLIED OVER ALSAN TRAFIK RS MEMBRANE. USE TEMPORARY PROTECTION AS REQUIRED TO KEEP MORTAR FROM FALLING INTO JOINT.

ACCEPTABLE ALSAN RS TRAFFIC SURFACING STOPPED @ SIDE OF MOVING JOINT AS SHOWN (TYP.)

ALSAN RS PRIMER OR APPROVED MOISTURE MITIGATION PRIMER APPLIED TO PREPARED SUBSTRATE (TYP.)

HOLD BACK SURFACING MIN. 1/2" (13mm) FROM EDGE OF JOINT.

GRIND & RECESS CONCRETE AS REQUIRED TO ALLOW FLUSH INSTALLATION OF ALSAN TRAFIK RS MEMBRANE JOINT FLASHING.

DE-BONDING TAPE SIZED TO ACCOMMODATE MOVEMENT & CENTERED IN JOINT OPENING.

2-PLY STEPPED ALSAN TRAFIK RS FLASH MEMBRANE EXTEND TOP PLY 4" (100 mm) ONTO PREPARED & PRIMED SUBSTRATE.

ACCEPTABLE COMPRESSIBLE FILLER OR EPOXY-SET PREFORMED IMPERMEABLE COMPRESSIBLE JOINT SEALANT SYSTEM (BY OTHERS)

EXPANSION GAP 1/2" (13 mm)  
UP TO 2" (50 MM) MAXIMUM

SOPREMA DETAIL DRAWINGS: REFER TO SOPREMA AND OTHER RELATED PUBLISHED DOCUMENTATION, PRODUCT DATA SHEETS (PDS) AND SAFETY DATA SHEETS (SDS) FOR ADDITIONAL INFORMATION. ALL DETAIL DRAWINGS AND RELATED INSTALLATION GUIDELINES ARE PROVIDED BY SOPREMA FOR THE SOLE PURPOSE OF ISSUING A SOPREMA WARRANTY. ACCORDINGLY, THE DETAIL DRAWINGS ARE NOT OFFERED, AND SHOULD NOT BE CONSIDERED, AS A SUBSTITUTE FOR PROFESSIONAL DESIGN SERVICES.



US CORPORATE ADDRESS  
310 QUADRAL DRIVE  
WADSWORTH, OHIO 44281  
www.soprema.us  
Tel: 330.334.0066

PROJECT:	DRAWN BY: SOPREMA TECHNICAL SUPPORT, DWALDRON		
	NO.:	REVISION:	DATE:
TITLE: <b>ALSAN TRAFIK RS PARTIALLY REINFORCED WATERPROOFING &amp; SURFACING EXPANSION JOINT @ CURBLINE</b>	DATE: 1-15-2022		DRAWING NUMBER: <b>US.RTN.08.J02K</b>
	SCALE: NTS		