

1. SIZE WIDTH OF DE-BONDING TAPE TO PROVIDE UN-ADHERED AREA MINIMUM 5 TIMES LARGER THAN THE MAXIMUM ANTICIPATED EXPANSION. MEMBRANE COVER STRIP MUST EXTEND PAST DE-BONDING AS INDICATED BELOW (TYP.)
2. DO NOT APPLY PRIMER AT VERTICAL SURFACES OF PREPARED RECESS.
3. INSTALL NEW JOINT SYSTEM DURING MEDIAN TEMPERATURES TO AVOID RAISED LOOP WHEN DECK EXPANDS DURING HIGH TEMPERATURES.

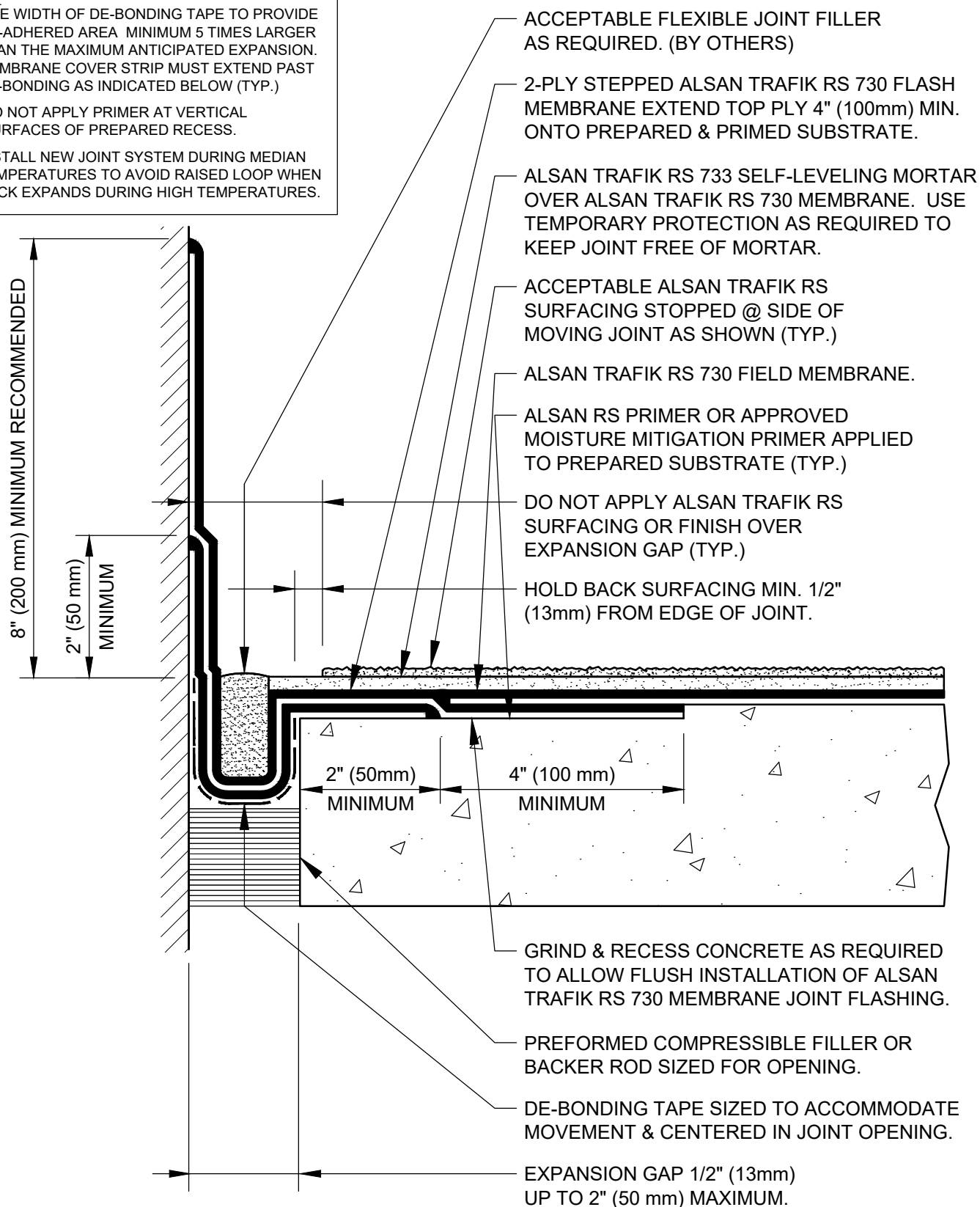

US CORPORATE ADDRESS  
310 QUADRAL DRIVE  
WADSWORTH, OHIO 44281  
www.soprema.us  
Tel: 330 334 0066

TITLE:

## ALSAN TRAFIK RS FULLY REINFORCED WATERPROOFING & SURFACING WALL JOINT (1/2" to 2" MAX. WIDTH)

SCALE: NTS

US.RTR.08.J02F

USAGE OF THIS DETAIL IS GOVERNED BY THE TERMS OF SERVICE FOR SOPREMA DETAILS.  
PLEASE CONSULT THESE TERMS OF SERVICE PRIOR TO UTILIZING THIS DRAWING.