

ONE OR TWO LANE TRAFFIC RAMP W/ TRACTION STRIPS  
& DIRECTIONAL MARKINGS AS REQUIRED.

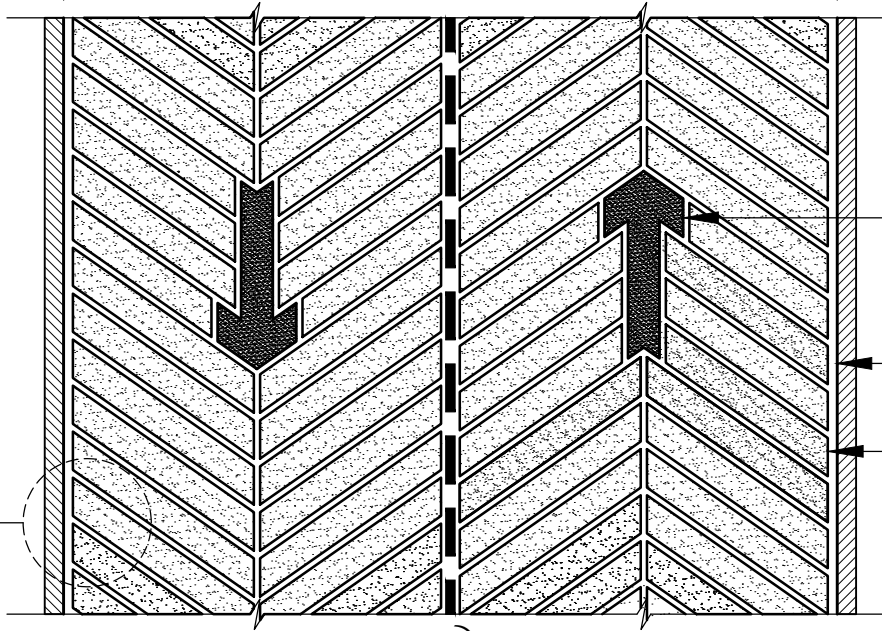

DIRECTIONAL MARKINGS AS  
REQUIRED. MASK & APPLY  
FULL DEPTH W/ALSAN TRAFIK  
RS SURFACING AS REQUIRED.

LINE OF BUILDING WALL,  
CURB OR RAMP EDGE.

ALSAN TRAFIK RS 789 LT OR  
ALSAN TRAFIK RS 790 HT TRACTIO  
ON ALSAN TRAFIK RS MORTAR  
AS SPECIFIED OR REQUIRED.

+/- 4" (100 mm)

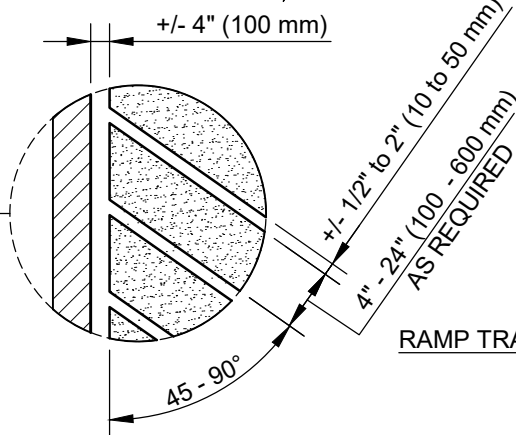

RAMP TRACTION STRIP PLAN VIEW

**GENERAL NOTE:**

TRACTION STRIP LAYOUT DEPICTED IS ONLY A SUGGESTED  
LAYOUT. OWNER AND/OR OWNERS REPRESENTATIVE MUST  
DETERMINE FINAL TRACTION STRIP LAYOUT, DIRECTIONAL  
MARKINGS & SIGNAGE. SOPREMA RECOMMENDS MARKINGS  
& LINEWORK BE APPLIED IN FULL DEPTH COLOR USING  
ALSAN TRAFIK RS 789 LT OR ALSAN TRAFIK RS 790 HT  
RESIN SURFACING AS MAY BE APPROPRIATE.

ALSAN TRAFIK RS 789 LT OR 790 HT  
TRACTION STRIPS AS REQUIRED.

ALSAN TRAFIK RS 733 SELF-LEVELING MORTAR  
OVER ALSAN TRAFIK RS 730 MEMBRANE.

PREPARE, LEVEL & PATCH SUBSTRATE W/  
ALSAN TRAFIK RS 733 SELF-LEVELING MORTAR  
AFTER PRIMING & PRIOR TO APPLICATION OF  
ALSAN TRAFIK RS 730 MEMBRANE.

ALSAN TRAFIK RS 730 REINFORCED MEMBRANE  
WHERE SPECIFIED OR REQUIRED.

ALSAN RS PRIMER OR APPROVED  
MOISTURE MITIGATION PRIMER APPLIED  
TO PREPARED SUBSTRATE (TYP.)



+/- 1/8" (3mm) TO 2" (50mm)  
BREAK AS REQUIRED

AS DESIRED

**SECTION THRU TRACTION & DIRECTIONAL STRIPING**

SOPREMA DETAIL DRAWINGS: REFER TO SOPREMA AND OTHER RELATED PUBLISHED DOCUMENTATION, PRODUCT DATA SHEETS (PDS) AND SAFETY DATA SHEETS (SDS) FOR  
ADDITIONAL INFORMATION. ALL DETAIL DRAWINGS AND RELATED INSTALLATION GUIDELINES ARE PROVIDED BY SOPREMA FOR THE SOLE PURPOSE OF ISSUING A SOPREMA  
WARRANTY. ACCORDINGLY, THE DETAIL DRAWINGS ARE NOT OFFERED, AND SHOULD NOT BE CONSIDERED, AS A SUBSTITUTE FOR PROFESSIONAL DESIGN SERVICES.



US CORPORATE ADDRESS  
310 QUADRAL DRIVE  
WADSWORTH, OHIO 44281  
www.soprema.us  
Tel: 330.334.0066

PROJECT:

TITLE:

**ALSAN TRAFIK RS  
WATERPROOFING & SURFACING  
RAMP TRACTION & DIRECTIONAL STRIPING**

DRAWN BY: SOPREMA TECHNICAL SUPPORT, DWALDRON

NO.:

REVISION:

DATE:

DATE: 1-15-2024

SCALE: NTS

DRAWING NUMBER:

**US.RTT.02.M03**

USAGE OF THIS DETAIL IS GOVERNED BY THE TERMS OF SERVICE FOR SOPREMA DETAILS.  
PLEASE CONSULT THESE TERMS OF SERVICE PRIOR TO UTILIZING THIS DRAWING.