

DRAWING MUST BE VIEWED IN ADOBE READER TO ENABLE CUSTOM LAYERING

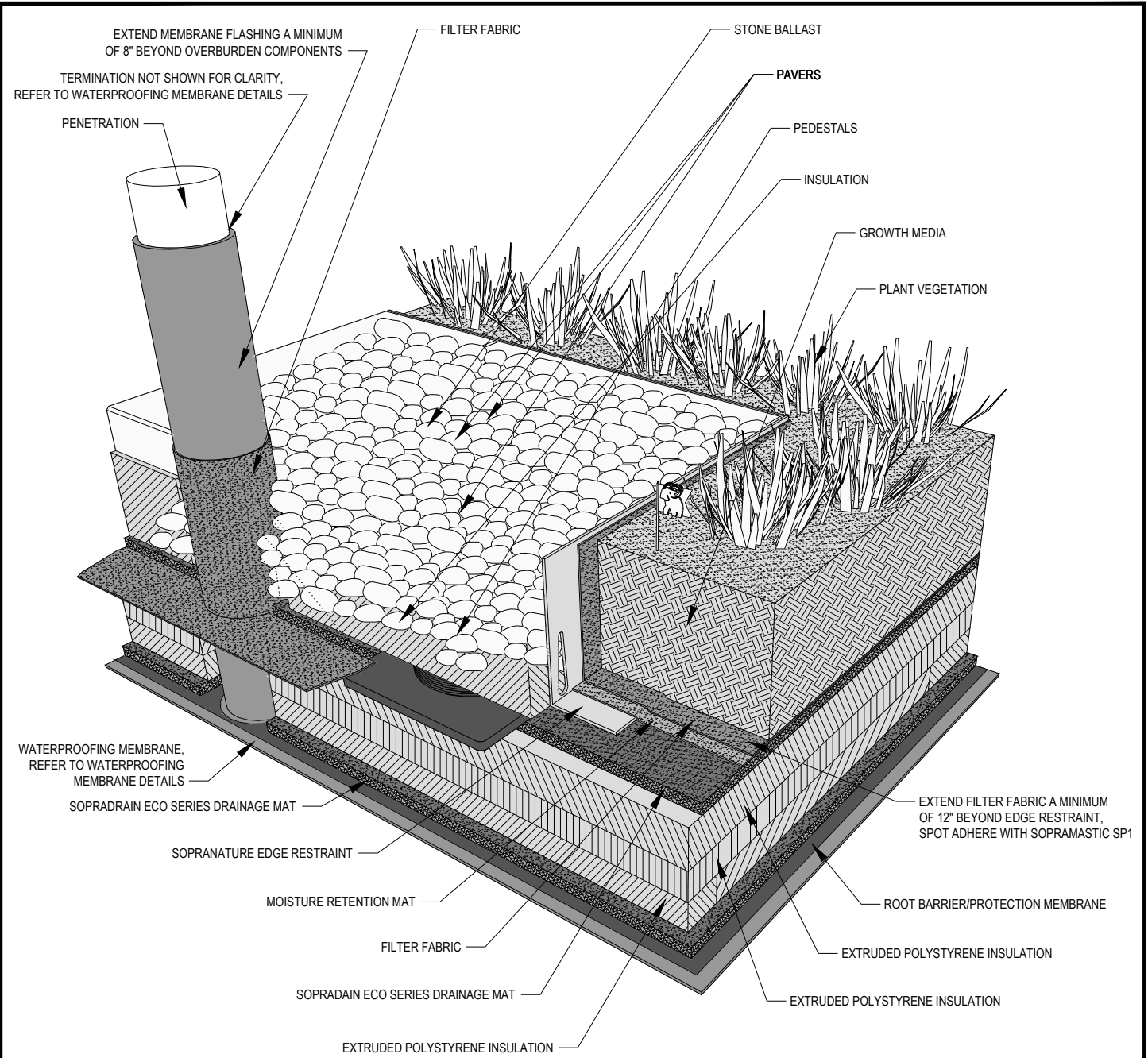

NOTES:

1. SOPREMA DETAIL DRAWINGS: REFER TO SOPREMA AND OTHER RELATED PUBLISHED DOCUMENTATION, PRODUCT DATA SHEETS (PDS) AND SAFETY DATA SHEETS (SDS) FOR ADDITIONAL INFORMATION. ALL DETAIL DRAWINGS AND RELATED INSTALLATION GUIDELINES ARE PROVIDED BY SOPREMA FOR THE SOLE PURPOSE OF ISSUING A SOPREMA WARRANTY. ACCORDINGLY, THE DETAIL DRAWINGS ARE NOT OFFERED, AND SHOULD NOT BE CONSIDERED, AS A SUBSTITUTE FOR PROFESSIONAL DESIGN SERVICES.
2. A MINIMUM 12 IN "VEGETATION FREE ZONE" SHALL BE INSTALLED TO SEPARATE THE VEGETATIVE SYSTEM FROM PENETRATIONS.
3. ROOT BARRIERS ARE REQUIRED ABOVE STYRENE BUTADIENE STYRENE (SBS) AND HOT RUBBERIZED ASPHALT MEMBRANES. PROTECTION MEMBRANES ARE REQUIRED ABOVE POLYMETHYL METHACRYLATE (PMMA), POLYMETHACRYLATE (PMA), AND POLYVINYL CHLORIDE (PVC) MEMBRANES.



US CORPORATE ADDRESS
 310 QUADRAL DRIVE
 WADSWORTH, OHIO 44281
 www.soprema.us
 Tel: 330.334.0066

PROJECT:	DRAWN BY: SOPREMA TECHNICAL SUPPORT, GGALLOWAY		
TITLE: VEGETATIVE OVERBURDEN, INSULATED ABOVE MEMBRANE, PENETRATION	NO.:	REVISION:	DATE:
	DATE: 1.7.2015	DRAWING NUMBER: US.WPO.04.01	
	SCALE: NTS		

DRAWN BY: SOPREMA TECHNICAL SUPPORT, GGALLOWAY		
NO.:	REVISION:	DATE:
DATE: 1.7.2015	DRAWING NUMBER: US.WPO.04.01	
SCALE: NTS		