

SOPRANATURE[®] METAL EDGING

Aluminum Edging System for Vegetative Roofing

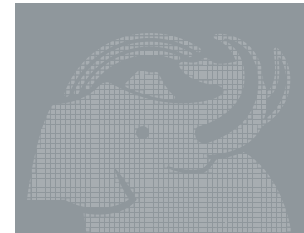
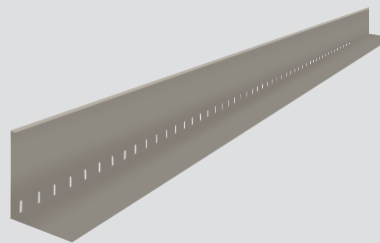

APPLICATIONS

VEGETATED

PRODUCT DATA SHEET PDS10462 - REV 230606

PRODUCT NUMBERS:

Contact SOPREMA[®] Customer Service or your sales representative for size options and special order requirements.

DESCRIPTION & FEATURES:

SOPRANATURE METAL EDGING is a lightweight, durable aluminum edging designed to retain planting media, stones, pavers, and tiles in a vegetated roofing system. Multiple height options are available and can be ordered with a solid or slotted edge. Inside and outside corners are available for a complete assembly.

- Constructed from durable 16 ga (0.051 in) aluminum 5052-H32 with a mill finish
- Slotted edge designed to promote the flow of water

APPLICATION:

Install the **SOPRANATURE METAL EDGING** directly over the drainage boards, overlapping edges by 1 in (25 mm). Attach the edging pieces along the vertical face with a self-piercing stainless steel screw at a 1/2 in. For 10 and 12 in metal edging, material must have supporting screws on both sides, they cannot be free standing.

Refer to SOPREMA's published technical literature for additional details and application requirements.

STORAGE:

Store in a clean, dry location and cover as necessary to protect from environmental damage such as extreme cold, heat or moisture.

WARRANTY:

For more information refer to www.SOPREMA.us or contact your SOPREMA representative.

DETAIL:

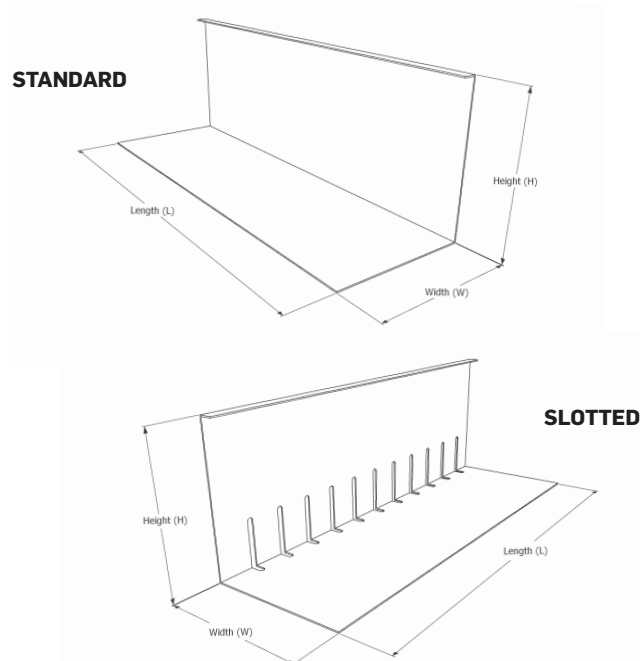

TECHNICAL INFORMATION & TESTING:

METAL EDGING	
PROPERTY	VALUE
Height x width, in (mm)	4 x 4 (100 x 100)
	6 x 6 (150 x 150)
	8 x 8 (200 x 200)
	10 x 10 (250 x 250)
	12 x 12 (300 x 300)
Length, ft (m)	8 (2.4)

