

DRAWING MUST BE VIEWED IN ADOBE READER TO ENABLE CUSTOM LAYERING

ALSAN RS 230 FLASH OR ALSAN RS 260 LO FLASH

ALSAN RS FLEECE

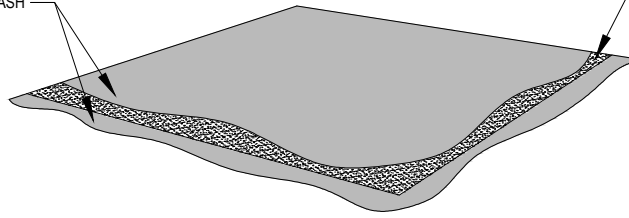

FLASHINGS

COLPHENE 180 FR GR, FIELD PROTECTION COURSE

COLPHENE 180 SANDED OR COLPHENE SANDED, FIELD PROTECTION COURSE

SOPRABOARD, FIELD PROTECTION COURSE

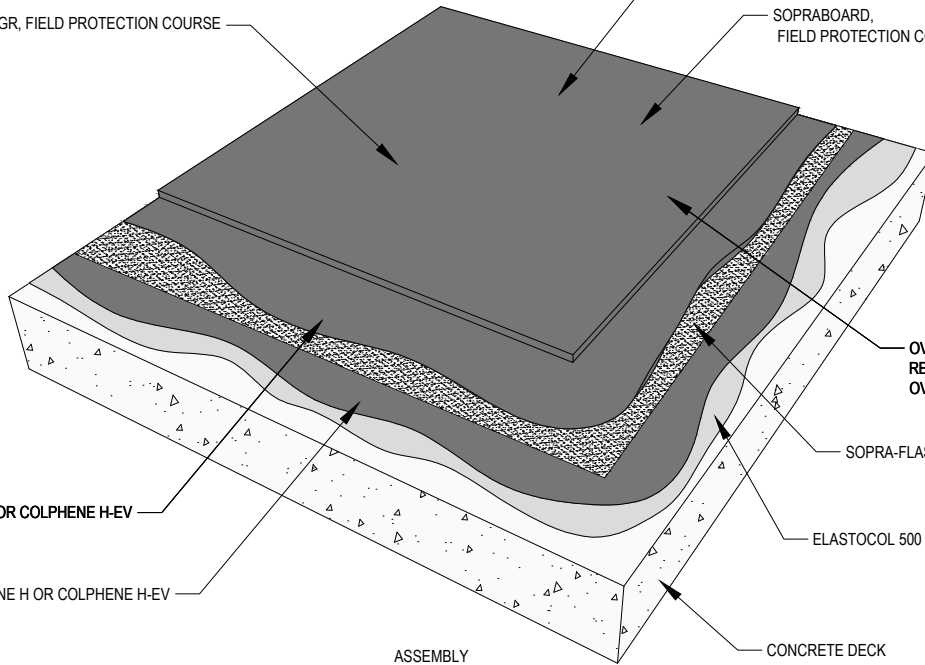

OVERBURDEN NOT SHOWN FOR CLARITY, REFER TO WATERPROOFING OVERBURDEN DETAILS

COLPHENE H OR COLPHENE H-EV

SOPRA-FLASH R

ELASTOCOL 500 OR ELASTOCOL 350

COLPHENE H OR COLPHENE H-EV

CONCRETE DECK

ASSEMBLY

NOTES:

- SOPREMA DETAIL DRAWINGS: REFER TO SOPREMA AND OTHER RELATED PUBLISHED DOCUMENTATION, PRODUCT DATA SHEETS (PDS) AND SAFETY DATA SHEETS (SDS) FOR ADDITIONAL INFORMATION. ALL DETAIL DRAWINGS AND RELATED INSTALLATION GUIDELINES ARE PROVIDED BY SOPREMA FOR THE SOLE PURPOSE OF ISSUING A SOPREMA WARRANTY. ACCORDINGLY, THE DETAIL DRAWINGS ARE NOT OFFERED, AND SHOULD NOT BE CONSIDERED, AS A SUBSTITUTE FOR PROFESSIONAL DESIGN SERVICES.



US CORPORATE ADDRESS
310 QUADRAL DRIVE
WADSWORTH, OHIO 44281
www.soprema.us
Tel:330.334.0066

PROJECT:

TITLE:

**COLPHENE H, NON-INSULATED,
WATERPROOFING ASSEMBLY WITH
LIQUID APPLIED FLASHINGS**

DRAWN BY: SOPREMA TECHNICAL SUPPORT, GGALLOWAY

NO.:

REVISION:

DATE:

DATE: 11.18.2022

SCALE: NTS

DRAWING NUMBER:

US.WPMHRA.01.02

USAGE OF THIS DETAIL IS GOVERNED BY THE TERMS OF SERVICE FOR SOPREMA DETAILS. PLEASE CONSULT THESE TERMS OF SERVICE PRIOR TO UTILIZING THIS DRAWING.